



2025 NSW ACE
WINTER MEETING

Expecting the unexpected:

STAYING AHEAD IN
OBSTETRIC ANAESTHESIA

Saturday 14 June 2025
HILTON HOTEL SYDNEY

**Healthcare
Industry
Prospectus**

Expecting the unexpected:

STAYING AHEAD IN
OBSTETRIC ANAESTHESIA



Join us at the Hilton Hotel Sydney on Saturday 14 June 2025 for the combined Australian and New Zealand College of Anaesthetists (ANZCA) and the Australian Society of Anaesthetists (ASA) 2025 NSW ACE Winter Meeting.

The meeting will feature updates on post partum haemorrhage – updated guidelines, thrombocytopenia in pregnancy; managing the hypertensive patient for caesarean section, neuropraxia of the needle, ANZCA emergency response workshops and newborn resuscitation workshops. Please see the program in the prospectus below for all the speakers and workshop information.

Sponsorship opportunities details are provided below and are designed to allow sponsors maximum access to delegates during the meeting. We expect 180-200 delegates to attend the meeting, based on previous NSW ACE Winter Meetings.

For further information, please contact NSW Events Coordinator Jessica Horne on +61 2 8974 9102 or jhorne@anzca.edu.au

2025 NSW ACE Winter Meeting Run Sheet

| | |
|---------|--|
| 7am | Sponsors bump in – set up displays for trade exhibition |
| 8am | Delegates arrive – trade exhibition commences <ul style="list-style-type: none">• registration and coffee commence |
| 8.55am | Guests seated – plenary session commences |
| 10.45am | Morning tea – trade exhibition |
| 1pm | Lunch – trade exhibition |
| 3.45pm | Afternoon tea – trade exhibition |
| 4.30pm | Sponsors can bump out from this time |
| 5.05pm | Meeting concludes |

Expecting the unexpected:

STAYING AHEAD IN
OBSTETRIC ANAESTHESIA



Program

| Session 1: Talks | | Session Chair: Dr Kim Gray and Dr John Neal |
|---|---|---|
| 8.55-9am | Conference Welcome | Dr Kim Gray, Anaesthetist, Royal Prince Alfred Hospital Dr John Neal Anaesthetist and Intensive Care Medicine Specialist, Coffs Clinical Network |
| 9-9.45am | Trauma Informed Care in Anaesthesia | Dr Morgan Edwards, Consultant Anaesthetist, Obstetric Lead, Te Whatu Ora Waitematā New Zealand |
| 9:45-10:30am | Birthing on Country | Dr Marilyn Clarke Clinical Director Obstetrics and Gynaecology , Coffs Clinical Network |
| 10.30-10.45am | Question and Answer Panel | Dr Morgan Edwards Consultant Anaesthetist, Obstetric Lead, Te Whatu Ora Waitematā New Zealand Dr Marilyn Clarke Clinical Director Obstetrics and Gynaecology, Coffs Clinical Network |
| 10.45-11.15am | Morning Tea | |
| Session 2: Talks | | Session Chair: Dr Natalie Purcell |
| 11.15-11.45am | Post Partum Haemorrhage - Updated Guidelines | Dr Morgan Edwards Consultant Anaesthetist, Obstetric Lead, Te Whatu Ora Waitematā New Zealand |
| 11.45am-12.15pm | Thrombocytopenia in Pregnancy | Dr Liane Khoo, Haematologist Royal Prince Alfred Hospital |
| 12.15-12.45pm | Managing the Hypertensive Patient for Caesarean Section | Dr Izreen Mohamed Iqbal Senior Staff Specialist Anaesthesia, St George Hospital |
| 12.45-1pm | Question and Answer Panel | Dr Morgan Edwards Consultant Anaesthetist, Obstetric Lead, Te Whatu Ora Waitematā New Zealand Dr Liane Khoo Haematologist, Royal Prince Alfred Hospital Dr Izreen Mohamed Iqbal Senior Staff Specialist Anaesthesia, St George Hospital |
| Session 2: Breakouts | | |
| 11.15-11.45am 11.50am-12.20pm 12.30-1pm | Newborn Resuscitation | Dr Sally Wharton Senior Staff Specialist, Children's Hospital at Westmead Dr Kristen Schwager Visiting Medical Officer, Children's Hospital at Westmead |
| 11.15am-1pm | Advanced Life Support (Cardiac Arrest) | Dr Anthony Padley VMO Anaesthetist, Blacktown Hospital |
| 11.15am-1pm | Can't Intubate Can't Oxygenate | Dr Laurence Boss Senior Staff Specialist, St George Public Hospital |
| 11.15am-1pm | Acute Severe Behavioural Disturbance | Dr Suyin Tan Anaesthetist and Pain Medicine Physician, South East Regional Hospital Bega |
| 11.15am-1.15pm | Opioid Induced Ventilatory Impairment | Dr Gavin Pattullo Specialist Anaesthetist and Pain Medicine Physician, Private Practise, Sydney |

Expecting the unexpected:

STAYING AHEAD IN
OBSTETRIC ANAESTHESIA



| | | |
|----------------------|--|--|
| 1-2pm | Lunch | |
| Session 3: Talks | | Session Chair: Dr Sharon Tivey |
| 2-2.30pm | Neuropraxia of the Needle | Dr Morgan Edwards Consultant Anaesthetist, Obstetric Lead, Te Whatu Ora Waitematā New Zealand |
| 2.30-3pm | Walking Epidurals - are we there yet? | Dr Catherine Traill VMO Anaesthetist, Royal North Shore Hospital |
| 3-3.30pm | Pain on a Friday Afternoon | Dr Jason Chow Clinical Lead Pain Service for Women, Royal Hospital for Women Randwick |
| 3.30-3.45pm | Question and Answer Panel | Dr Morgan Edwards Consultant Anaesthetist, Obstetric Lead, Te Whatu Ora Waitematā New Zealand Dr Catherine Traill Anaesthetist, Royal North Shore Hospital Dr Jason Chow Clinical lead Pain Service for Women, Royal Hospital for Women Randwick |
| Session 3: Breakouts | | |
| 2-2.45pm | The Dr Andrew Couch Memorial Award Session – Trainee Presentations | Dr Simon Martel VMO Anaesthetist, Liverpool Hospital |
| 2-3.45pm | Advanced Life Support (Cardiac Arrest) | Dr Anthony Padley VMO Anaesthetist, Blacktown Hospital |
| 2-3.45pm | Can't Intubate Can't Oxygenate | Dr Laurence Boss Senior Staff Specialist, St George Public Hospital |
| 2-3.45pm | Acute Severe Behavioural Disturbance | Dr Suyin Tan Anaesthetist and Pain Medicine Physician, South East Regional Hospital Bega |
| 2-4pm | Opioid Induced Ventilatory Impairment | Dr Gavin Pattullo Specialist Anaesthetist and Pain Medicine Physician, Private Practise, Sydney |
| 3.45-4.15pm | Afternoon tea | |
| Session 4: Talks | | Session Chair: Dr Kim Gray and Dr John Neal |
| 4.15-4.20pm | Dr Andrew Couch Memorial Award Presentation | Dr Simon Martel VMO Anaesthetist, Liverpool Hospital |
| 4:20-5pm | Obstetrics Morbidity and Mortality Session + Critical Reflection | Dr David Zalberg Staff Specialist Anaesthetist, Director of Obstetric Anaesthesia, ANZAAG Allergy Clinic, Royal Prince Alfred Hospital Dr Morgan Edwards Consultant Anaesthetist, Obstetric Lead, Te Whatu Ora Waitematā New Zealand Dr Izreen Mohamed Iqbal Senior Staff Specialist Anaesthesia, St George Hospital Dr Jason Chow Clinical Lead Pain Service for Women, Royal Hospital for Women Randwick |
| 5-5:05pm | Closing Remarks | Dr Kim Gray Anaesthetist, Royal Prince Alfred Hospital Dr John Neal Anaesthetist and Intensive Care Medicine Specialist, Coffs Clinical Network |

Expecting the unexpected:

STAYING AHEAD IN
OBSTETRIC ANAESTHESIA



Sponsorship opportunity

2025 NSW ACE Winter Meeting Sponsorship \$A2420 (incl GST)

Individual Sponsor acknowledgement/details within HCI tab of the event app including brochure display and individual sponsor alerts on the event app.

1 x 3 x 2 x 2.5 Booth with Fascia Sign

1 x trestle table and two chairs, with access to power

Attendance for two representatives including full catering on Saturday.

Ample time to network with delegates during the conference.

Company name and logo listed on the screen at the end of each session and at the end of the meeting.

Venue information

The conference will be held at the Hilton Hotel, George Street, Sydney. The trade area will be set up in the pre-function area adjacent to the Grand Ballroom. The Health Care Industry area will be co-located with the catering, ensuring there is a high volume of anaesthetists engaging with the exhibitors. The exhibition package includes 1- 2m x 3m x 2.5 m booth and one table and two chairs. The availability of trade booth spots will be on a first-come basis.

Healthcare industry registration

Sponsorship opportunities for this meeting are limited. To register your interest, please return the completed form on the final page together with payment. We hope that you will be interested in this opportunity to support the NSW anaesthesia community. We look forward to working with you and thank you in advance for your support.

Expecting the unexpected:

STAYING AHEAD IN
OBSTETRIC ANAESTHESIA

Floorplan

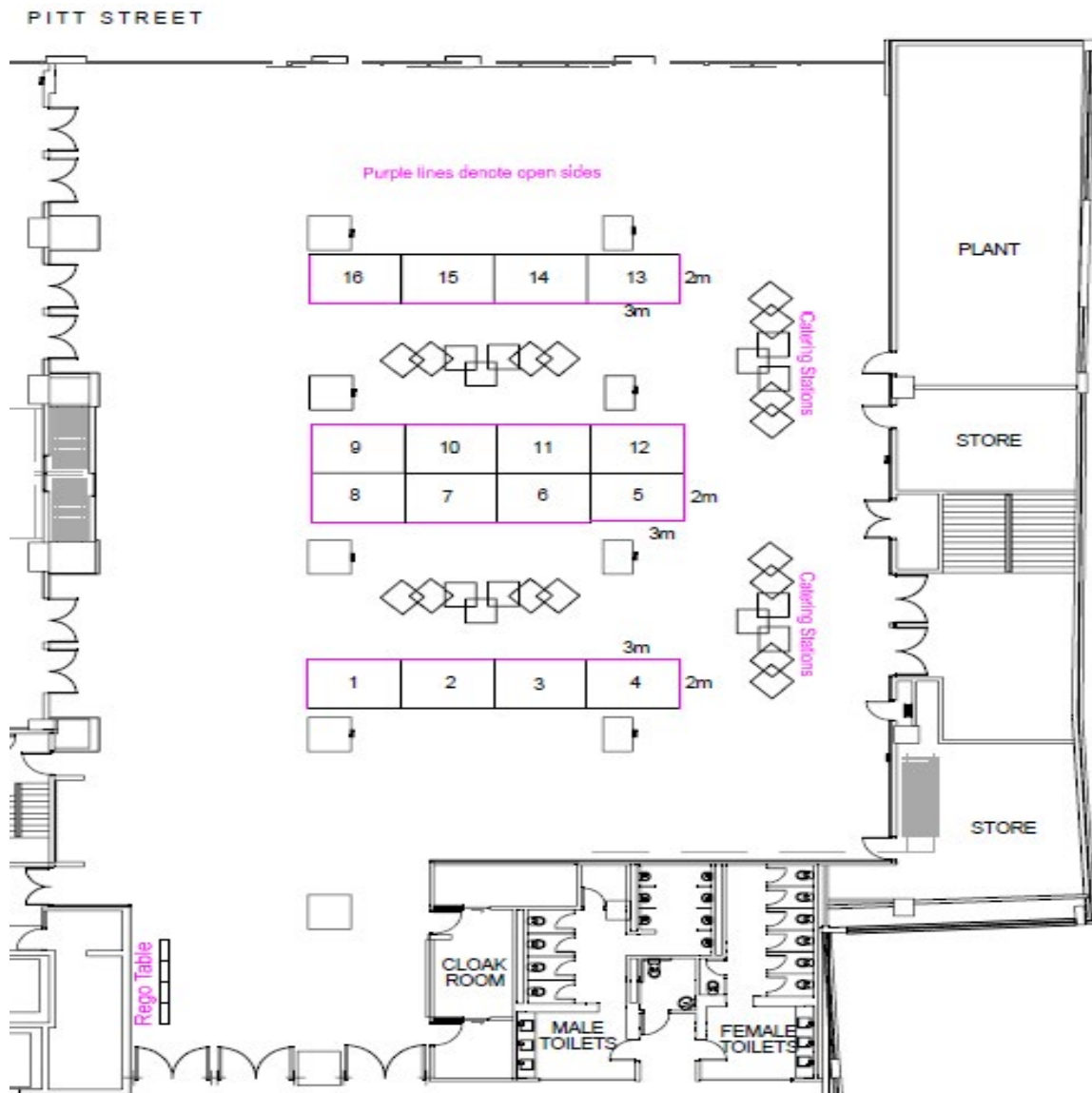

Expecting the unexpected:

STAYING AHEAD IN
OBSTETRIC ANAESTHESIA



Contact details

Company name:

Address:

Suburb/town:

Postcode:

State:

Country:

Website:

Name and position of main contact:

Mobile:

Email:

First representative:

Second representative:

Exhibition cost

Please confirm our sponsorship as follows:

Sponsorship: \$A2420

Additional registration fee per representative: \$242.00

Closing date for applications is Friday 30 May 2025.

Please note that FULL payment must be received prior to event.

Exhibition cost \$

Additional representative(s) \$

Please find our total remittance for \$

(including GST) for exhibition space

Payment details:

Payment options

I require a tax invoice to make payment

I will be paying via electronic funds transfer

Bank details will be supplied with your tax invoice
issued with your meeting confirmation.

Please send completed registration form to: jhorne@anzca.edu.au