

SAFETY ALERT



PO Box 718
Mona Vale
NSW 1660
Australia

+61 2 8401 9777
+61 2 8401 9788
info@linkhealthcare.com.au

ADRENALINE-LINK 1:10,000 1mg/10mL adrenaline (epinephrine) acid tartrate injection BP pre-filled syringe AUST R 210672

Warning: Compatible connector systems must be used with this product

For the attention of:

Intensive Care Unit Staff	Accident & Emergency Staff	Rapid Response Teams
Hospital Managers / CEOs	Hospital Pharmacists	Clinical Directors
Purchasing Managers	Nursing Managers	Supplies Managers
Risk Managers	Resuscitation Officers	Hospital personnel

Please bring this safety alert to the attention of all who need to be aware of it.

Link advises that not all connector systems are directly compatible with ADRENALINE-LINK pre-filled syringes (PFS).

Reports of blocked syringe bores have been received by the Therapeutic Goods Administration (TGA) and Link, which made it difficult or impossible to administer a dose of potentially life-saving medication. The use of incompatible connectors (and adaptors where required) may be a contributing factor to blocked syringes.

To ensure patient safety, Link is issuing this Safety Notice to ensure all users of ADRENALINE-LINK PFS product are aware of the connector compatibility issue.

The packaging of ADRENALINE-LINK PFS product has also been updated to include a warning statement alerting users that a compatible connector is required. A list of compatible connectors and adaptors is printed overleaf and is included in the leaflet with the product.

Note: Not all stock currently in supply will have this new labelling and warning statement. Please refer to the current stock you have and if these warnings are not on the current stock please make sure that all users of this product are aware of this Safety Notice.

Please find a full list of compatible connector and adaptor systems below.

This safety alert has been issued in consultation with the TGA.

Please contact Link Customer Service on 1800 181 060 if you have any queries.



Keiko Tredinnick
Product Manager - Hospital

***ATTENTION: CONNECTOR COMPATIBILITY**

The Adrenaline-Link pre-filled syringes are now compatible with:

- Baxter Healthcare - Clearlink needle free luer activated devices
- B.Braun Medical - Ultrasite/Safeflow connectors
- Becton Dickinson - BD Q-Syte™ connectors
- BMDi TUTA Healthcare - H-Port, N-Pulse and T-Site luer valve connectors
- CareFusion™ Maxplus Displacement connectors
- CareFusion™ SmartSite® Valve
- ICU Medical - CLC 2000 Connector

CONNECTORS TO BE USED IN CONJUNCTION WITH AN ADAPTOR

- ICU MEDICAL – **Microclave CONNECTOR** to be used with **CS-25 ADAPTOR**
- ICU MEDICAL – **Microclave Clear CONNECTOR** to be used with **CS-25 ADAPTOR**

Other connectors are not currently recommended

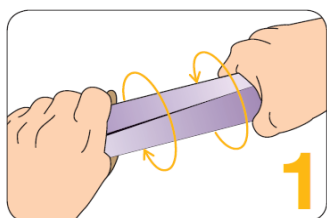

TWIST THE
BOX OPEN

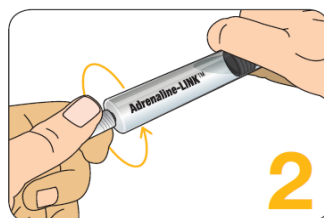

TWIST THE
CAP OFF THE
SYRINGE

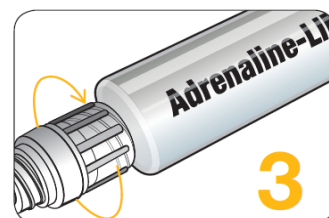

TWIST ON A
COMPATIBLE
CONNECTOR*

Adrenaline-LINK™ Pre-filled Syringe (PFS)

Your pre-filled adrenaline delivery solution^{1,2}

Ready in three twists¹

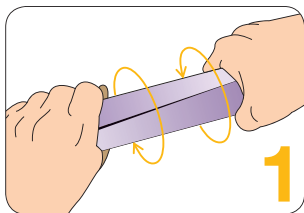

TWIST THE
BOX OPEN

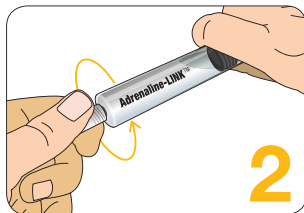

TWIST THE
CAP OFF THE
SYRINGE



TWIST ON A
COMPATIBLE
CONNECTOR*

*ATTENTION: CONNECTOR COMPATIBILITY

The Adrenaline-Link pre-filled syringes are now compatible with:

- Baxter Healthcare - Clearlink needle free luer activated devices
- B.Braun Medical - Ultrasite/Safeflow connectors
- Becton Dickinson - BD Q-Syte™ connectors
- BMDi TUTA Healthcare - H-Port, N-Pulse and T-Site luer valve connectors
- CareFusion™ Maxplus Displacement connectors
- CareFusion™ SmartSite® Valve
- ICU Medical - CLC 2000 Connector

CONNECTORS TO BE USED IN CONJUNCTION WITH AN ADAPTOR

- ICU MEDICAL – Microclave CONNECTOR to be used with CS-25 ADAPTOR
- ICU MEDICAL – Microclave Clear CONNECTOR to be used with CS-25 ADAPTOR

Other connectors are not currently recommended

LINK HEALTHCARE: Your one-stop solution for adrenaline

For all your adrenaline needs, LINK Healthcare has a range of ampoules and the Adrenaline-LINK™ 1:10,000 Pre-filled Syringe.¹

Contact our Customer Service team for more information on **1800 181 060**
or **customerservice@linkhealthcare.com.au**

PBS Information: This product is not listed on the PBS.

PLEASE REVIEW PRODUCT INFORMATION BEFORE PRESCRIBING.
APPROVED PRODUCT INFORMATION IS AVAILABLE ON REQUEST FROM
LINK HEALTHCARE ON 1800 181 060.

ADRENALINE-LINK INJECTION BP [adrenaline (epinephrine) acid tartrate] MINIMUM PRODUCT INFORMATION

INDICATION: 1:1,000 – emergency treatment of acute severe anaphylactic reactions due to insect bites, drugs and other allergens; symptomatic relief of respiratory distress due to bronchospasm. 1:10,000 – adjunct in the management of cardiac arrest. **CONTRAINDICATIONS:** sympathomimetic amines hypersensitivity; shock (excl. anaphylactic); cardiac dilatation; coronary insufficiency; hypertension; ischaemic heart disease; arrhythmias; cerebral arteriosclerosis; diabetes mellitus; hyperthyroidism; narrow angle glaucoma; organic brain damage; phaeochromocytoma; during general anaesthesia with halogenated hydrocarbons or cyclopropane; local anaesthesia in fingers, toes, ears, nose, genitalia; labour; conditions where vasopressor drugs may be contraindicated e.g. thyrotoxicosis; obstetrics when maternal BP >130/80 mmHg. **PRECAUTIONS:** administration of other beta-agonist sympathomimetics; elderly; patients with cardiovascular disease; phenothiazine induced circulatory collapse; cerebrovascular insufficiency; diabetes; hypertension; chronic lung disease; angina pectoris; prostatic hypertrophy; psychoneurosis; hyperthyroidism; long standing bronchial asthma; emphysema with degenerative heart disease; asthmatic children; parkinsonian syndrome; concurrent use with general anaesthesia; use in circulatory support; sodium metabisulfite hypersensitivity; not for intra-arterial, intracardiac admin; lactation; pregnancy category A. **INTERACTIONS:** other sympathomimetic agents; rapidly acting vasodilators; general anaesthetics; anti-arrhythmics; antihypertensives; alpha-blockers; nonselective beta blockers; some antihistamines; antidepressants incl. TCAs, MAOIs; thyroid hormones; drugs causing potassium loss; high-dose beta2 agonists; hypoglycaemic agents; incompatible with oxidising agents, alkalis, metals (incl Cu, Zn, Fe, Ag), see full PI for list of incompatible solutions. **ADVERSE EFFECTS:** fear, anxiety, tenseness, restlessness, disorientation, impaired memory, confusion, irritability, hallucinations, psychotic states, headache, weakness, dizziness, anorexia, nausea, vomiting, urinary dysfunction, tremor, hypokalaemia, psychomotor agitation, pallor, respiratory difficulty, hyperglycaemia, sweating, hypersalivation, cold extremities, insomnia, palpitations, tachycardia, cardiac arrhythmias, hypertension, flushing and hypotension. **DOSAGE/METHOD FOR USE:** 1:1,000: SC injection, IM injection (not in buttocks); 1:10,000: in emergency situations via slow IV injection. Cardiac arrest – Adults: 1mg IV, may be repeated every 3-5 mins. Children: 10 mcg/kg bodyweight IV, may be repeated every 3-5 mins. Severe anaphylaxis or asthma – Adults: usual initial dose of 100 to 500 mcg SC or IM. In severe anaphylactic shock, slow and cautious IV admin of 100 to 250 mcg may be administered. Children – 10 mcg/kg of bodyweight SC. Single paediatric dose should not exceed 500 mcg. Date of most recent amendment: 22 August 2017.

REFERENCES: 1. Adrenaline-LINK™ Injection BP Product Information (August 2017)
2. Australian Register of Therapeutic Goods <https://www.ebs.tga.gov.au> Accessed November 2017